

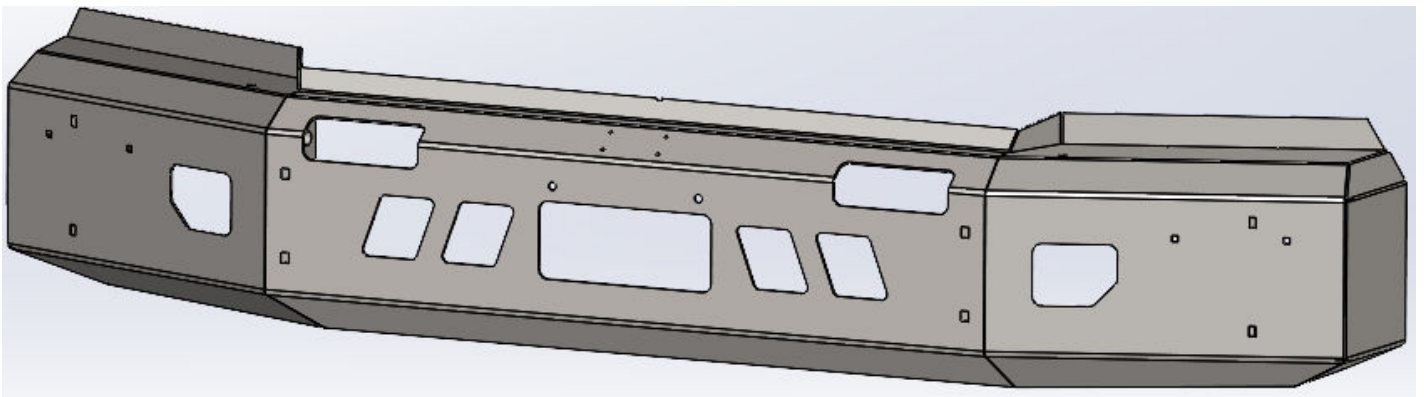

2013-2023 KENWORTH T880 SET BACK AXLE XD SERIES FRONT BUMPER INSTALLATION INSTRUCTIONS



SAFETY

Know safety, no injury. Know injury, no safety. ~Author Unknown

If there are any questions, call 1-855-HHTOUGH

READ ALL SAFETY INSTRUCTIONS BEFORE INSTALLATION

- FOLLOW ALL INSTRUCTIONS FOR PROPER ASSEMBLY
- WEAR APPROPRIATE EYE PROTECTION
- EXERCISE CARE WHEN LIFTING COMPONENTS
- USE APPROPRIATE TORQUE FOR BOLTS
- RE-TORQUE HARDWARE AT EVERY OIL CHANGE.

Suggested Torque Values For Steel Grade 5 Standard Bolts		
BOLT DIAMETER (INCH)	THREADS PER INCH	TORQUE (POUND - FEET)
1/4	20	7
5/16	18	14
3/8	16	25
7/16	14	40
1/2	13	60
9/16	12	88
5/8	11	120
3/4	10	200
7/8	9	302
1	8	466

Suggested Torque Values For Steel Grade 8.8 Metric Bolts		
BOLT DIAMETER (mm)	THREAD PITCH (mm)	TORQUE (POUND-FEET)
6	1.0	7
8	1.25	16
10	1.5	32
12	1.75	55
14	2.0	88
16	2.0	140
18	2.5	195
20	2.5	275
22	2.5	375
24	3.0	475





I. PARTS LIST

Note: Brush guard configuration may differ.

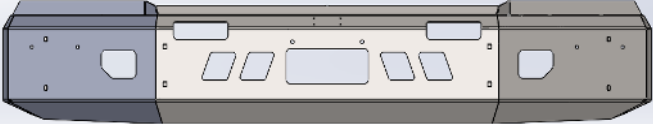
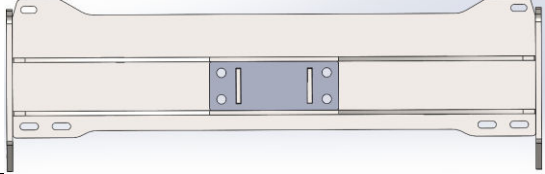
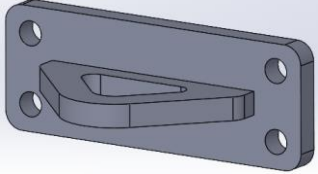
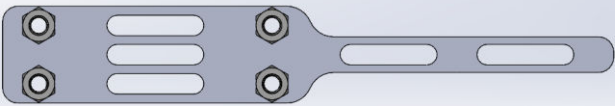
Item 1	XD SERIES FRONT BUMPER	QTY. 1	ITEM 2	INSTALL KIT	QTY. 1
			✓ HARDWARE KIT #1 (60K-56-0001) ✓ (2) LICENSE PLATE MOUNT KIT		
Item 3	FRAME SUBWELDMENT	QTY. 1	Item 4	TOW HOOK WELDMENT	QTY. 1
					
ITEM 5	WELDNUT TAB	QTY. 1			
					

REMOVE CONTENTS FROM BOX AND VERIFY ALL PARTS ARE PRESENT.

If there are any questions, call 1-855 HHTOUGH or email HHORDERS@hammerheadarmor.com

II. TOOL LIST

- ✓ 2 people required
- ✓ Basic tool set
- ✓ Blue masking tape
- ✓ 19mm socket
- ✓ 1 1/8" socket
- ✓ 1 1/8" wrench
- ✓ Ratchet extension

III. VEHICLE PREPARATION

1. Park vehicle on level surface.
2. Engage parking brake, chalk tires, and disconnect battery.
3. Using blue masking tape, mask along the profile of your truck above the bumper. This will help protect your truck from any accidental scratches.

IV. REMOVAL OF OE BUMPER

1. Using a 1 1/8" socket and a 1 1/8" wrench, remove 4 bolts attaching OE tow point to frame. Remove and set aside.



2. Using a 19mm socket or wrench, remove six bolts attaching OE bumper to frame of truck. Using a crane or hoist, hold weight of bumper while removing bolts. Remove bumper and set aside.



V. **INSTALLATION OF HAMMERHEAD BUMPER**

1. Using a 19mm socket and hardware from hardware kit #221, attach frame sub weldment (*ITEM 3*) to frame of truck as shown below. Do not fully tighten.

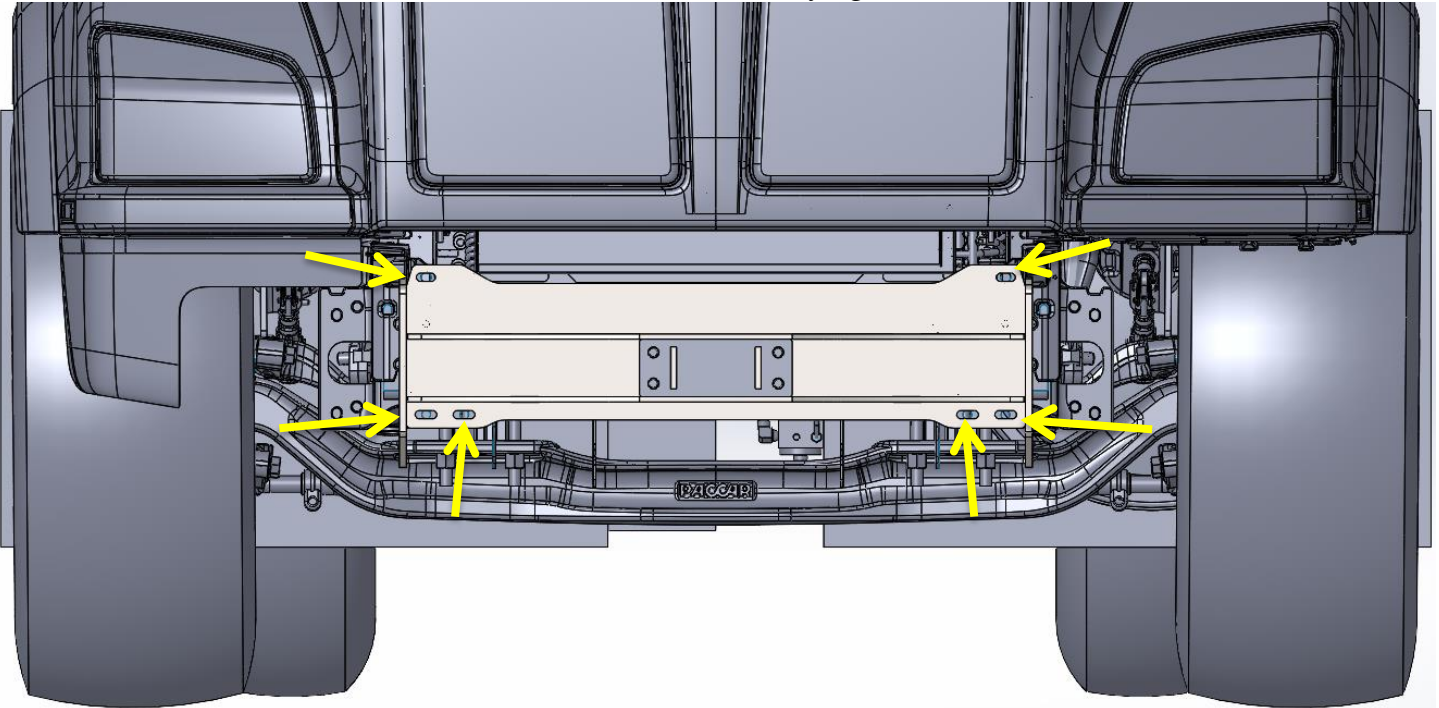

2. Slide weldnut tab into back of frame. Using a 1 1/8" wrench or socket and hardware from hardware kit #42, secure frame sub weldment to frame of truck as shown below. Adjust frame sub weldment to be centered on truck and fully tighten all hardware.

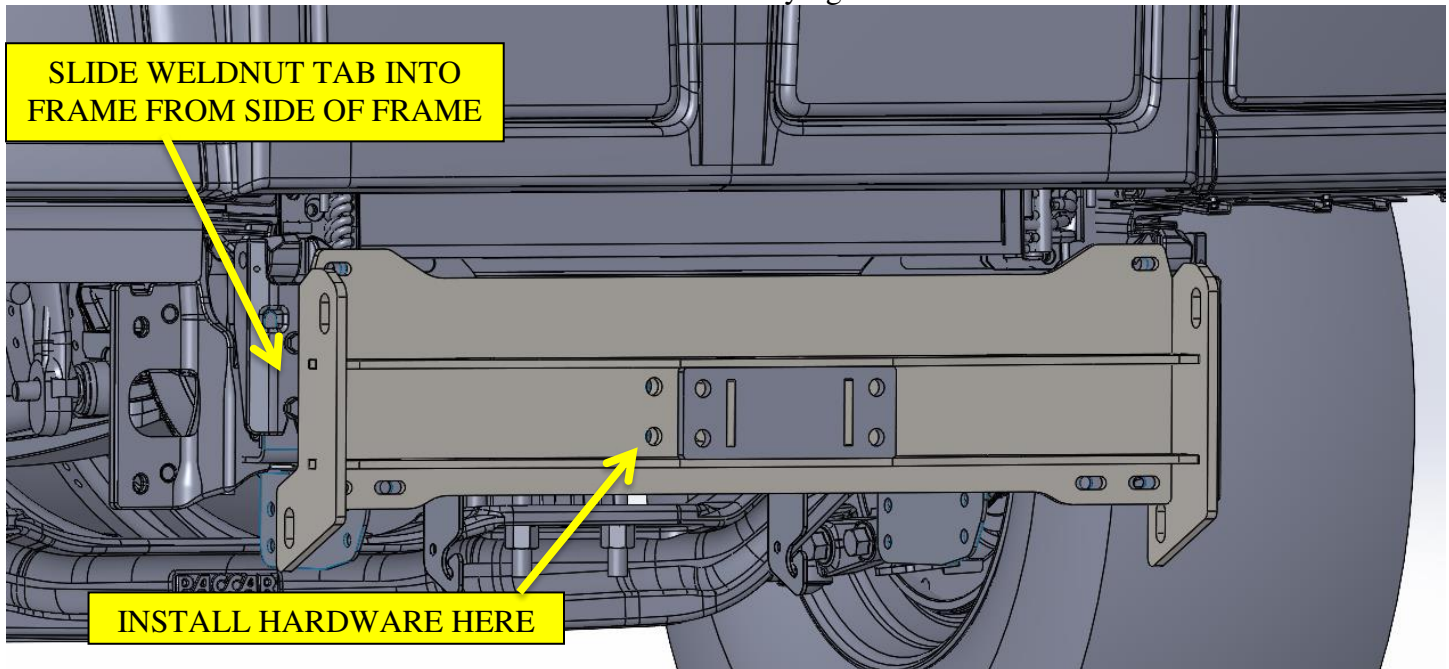

- Using a hoist or a few friends, attach bumper to frame subweldment using hardware kit #124 as shown below. Start all bolts before aligning bumper. Align bumper a minimum of 3/8" below fascia. When truck flexes off-road, this distance allows your bumper and body to have clearance. Fully tighten bolts with 1 1/8" socket and wrench. Extra hardware is included in hardware kit #42 to install tow hook to frame sub weldment.

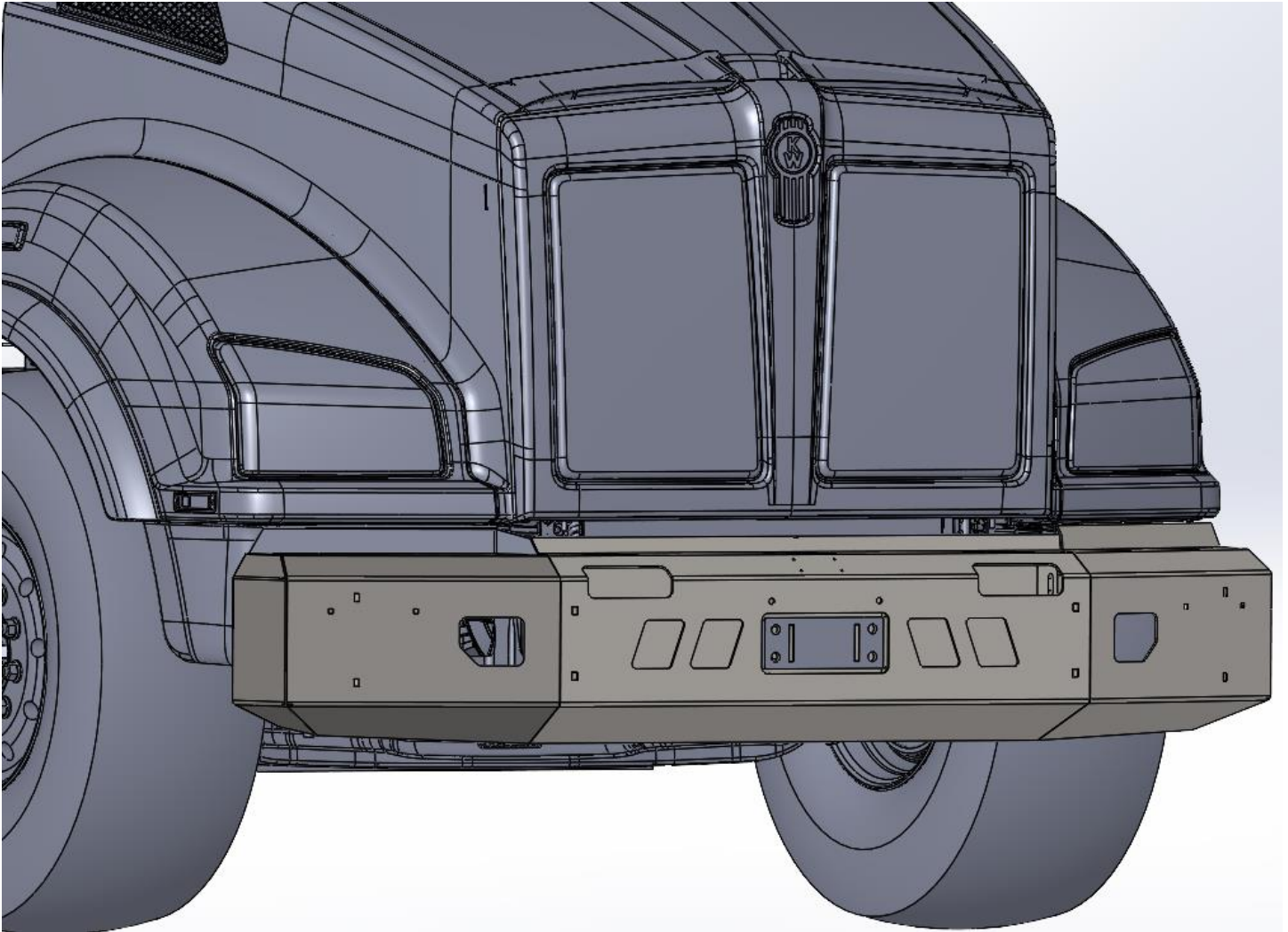

**Congratulations! Your product installation is now complete.
Thank you for your purchase!**