

1999-20XX Ford F250-550 CREW CAB 6.5' BED – BED ACCESS RUNNING BOARD INSTALLATION INSTRUCTIONS



SAFETY

Know safety, no injury. Know injury, no safety. ~Author Unknown

If there are any questions, call 1-855-HHTOUGH

- **READ ALL SAFETY INSTRUCTIONS BEFORE INSTALLATION**
 - FOLLOW ALL INSTRUCTIONS FOR PROPER ASSEMBLY
 - WEAR APPROPRIATE EYE PROTECTION
 - EXERCISE CARE WHEN LIFTING COMPONENTS
 - USE APPROPRIATE TORQUE FOR BOLTS
 - BLUE THREAD LOCKING COMPOUND IS RECOMMENDED ON ALL BOLTS
 - SUGGESTED TORQUE VALUES FOR STEEL GRADE SAE 5 BOLTS

BOLT DIAMETER (INCH)	TREADS PER INCH	TORQUE (POUND-FEET)
1/4	20	7
5/16	18	14
3/8	16	25
7/16	14	40
1/2	13	60
9/16	12	88
5/8	11	120
3/4	10	200
7/8	9	302
1	8	466



1999-20XX Ford F250 - F550

I. PARTS LIST

<u>QUANTITY</u>	<u>PART NUMBER</u>	<u>DESCRIPTION</u>
1	60P-56-0261	RIGHT RUNNING BOARD
1	60P-56-0260	LEFT RUNNING BOARD
1	60K-56-0023	HARDWARE KIT #23

II. TOOL LIST

1. A good friend
2. Basic tool kit
3. ½" socket

III. VEHICLE PREPARATION

1. In this step you will use hardware from kit #23. Install three spring nuts in cab at each running board mount location. (front mount, middle mount where doors meet, rear mount)

IV. RUNNING BOARD INSTALLATION

1. Identify the left running board. It will have a bottle opener (arrow) on the left side.

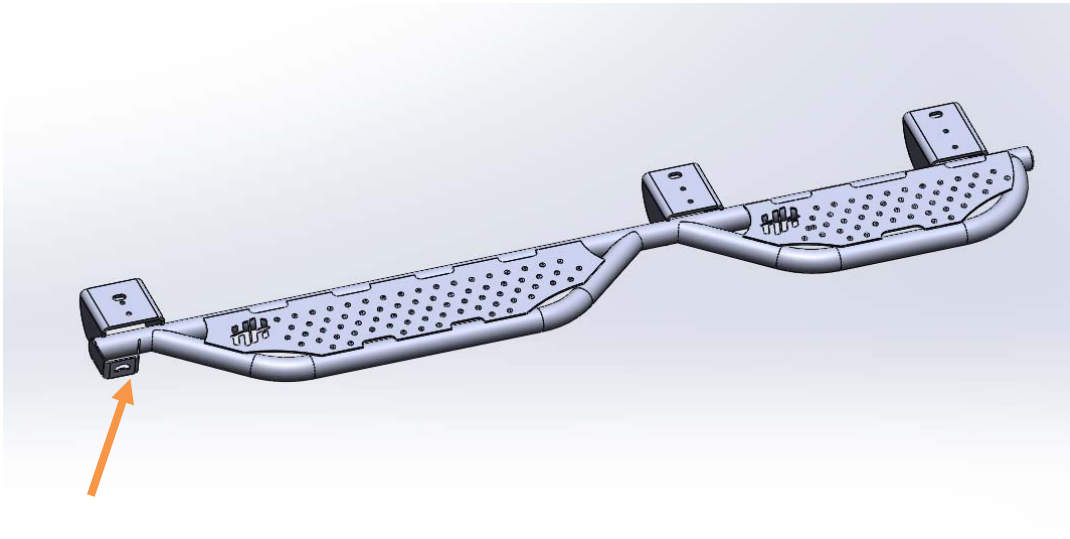

(Picture is for reference only; your running boards may differ.)

2. Have a good friend help you hold the running board up to the mounts.
3. In this step you will use hardware from kit #23. Using nine 5/16"-18x1.5" bolts, nine 5/16" lock washers and nine 5/16" flat washers, install running boards on vehicle. Tighten with ½" socket. Installation is now complete. Follow the same procedure for the right side of the vehicle.

CONGRATULATIONS!!