

# 2007-20XX CHEVY/GMC 2500-3500 CREW CAB 8' BED - BED ACCESS

## RUNNING BOARD INSTALLATION INSTRUCTIONS



# SAFETY

**Know safety, no injury. Know injury, no safety. ~Author Unknown**

- **READ ALL SAFETY INSTRUCTIONS BEFORE INSTALLATION**
  - FOLLOW ALL INSTRUCTIONS FOR PROPER ASSEMBLY
  - WEAR APPROPRIATE EYE PROTECTION
  - EXERCISE CARE WHEN LIFTING COMPONENTS
  - USE APPROPRIATE TORQUE FOR BOLTS
  - BLUE THREAD LOCKING COMPOUND IS RECOMMENDED ON ALL BOLTS
- SUGGESTED TORQUE VALUES FOR STEEL GRADE SAE 5 BOLTS

BOLT DIAMETER (INCH)	TREADS PER INCH	TORQUE (POUND-FEET)
1/4	20	7
5/16	18	14
3/8	16	25
7/16	14	40
1/2	13	60
9/16	12	88
5/8	11	120
3/4	10	200
7/8	9	302
1	8	466



2007-20XX CHEVY/GMC 2500-3500 CREW CAB 8' BED – BED ACCESS

## I. PARTS LIST

<u>QUANTITY</u>	<u>PART NUMBER</u>	<u>DESCRIPTION</u>
1	60P-56-0364	RIGHT SIDE RUNNING BOARDS
1	60P-56-0365	LEFT SIDE RUNNING BOARDS

## II. TOOL LIST

1. A good friend
2. Basic tool kit
3. 21mm socket

## III. VEHICLE PREPARATION

1. Using 21mm socket, remove three cab bolts.

Front



Middle



Rear



2007-20XX CHEVY/GMC 2500-3500 CREW CAB 8' BED – BED ACCESS

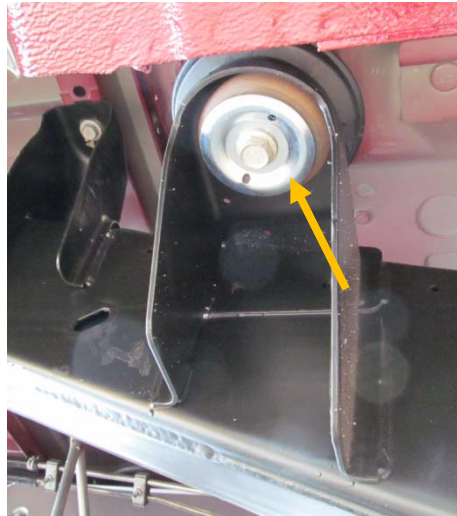

#### IV. RUNNING BOARD INSTALLATION

1. Identify the left running board. It will have a bottle opener (arrow) on the left side.

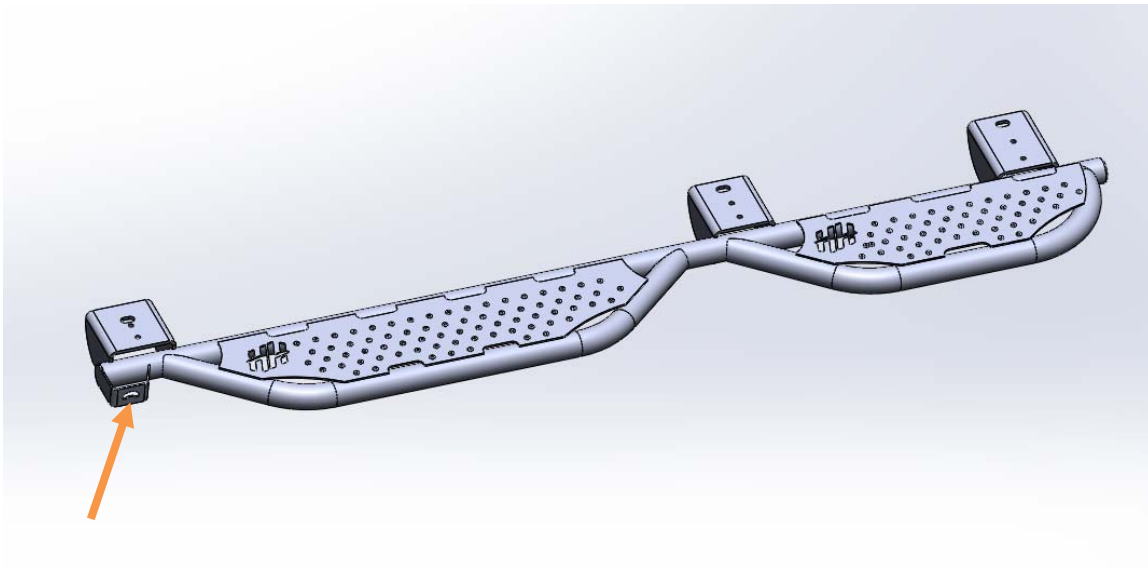

(Picture is for reference only; your running boards may differ.)

2. Place OEM cab bushings/washers on top of Hammerhead running board mounts.
3. Have a good friend help you hold the running board up to the mounts. Install with OEM hardware.
4. Tighten all hardware. Installation is now complete. Follow the same procedure for the right side of the vehicle.

**CONGRATULATIONS!!**