

# 2015-20XX FORD F-150 SUPER CREW 5.5' BED – BED ACCESS

## RUNNING BOARD INSTALLATION INSTRUCTIONS



## SAFETY

**Know safety, no injury. Know injury, no safety. ~Author Unknown**

If there are any questions, call 1-855-HHTOUGH

- **READ ALL SAFETY INSTRUCTIONS BEFORE INSTALLATION**
  - FOLLOW ALL INSTRUCTIONS FOR PROPER ASSEMBLY
  - WEAR APPROPRIATE EYE PROTECTION
  - EXERCISE CARE WHEN LIFTING COMPONENTS
  - USE APPROPRIATE TORQUE FOR BOLTS
  - BLUE THREAD LOCKING COMPOUND IS RECOMMENDED ON ALL BOLTS
  - SUGGESTED TORQUE VALUES FOR STEEL GRADE SAE 5 BOLTS

BOLT DIAMETER (INCH)	TREADS PER INCH	TORQUE (POUND-FEET)
1/4	20	7
5/16	18	14
3/8	16	25
7/16	14	40
1/2	13	60
9/16	12	88
5/8	11	120
3/4	10	200
7/8	9	302
1	8	466



2015-20XX Ford F-150

## I. PARTS LIST

<u>QUANTITY</u>	<u>PART NUMBER</u>	<u>DESCRIPTION</u>
1	60P-56-0367	RIGHT SIDE RUNNING BOARDS
1	60P-56-0368	LEFT SIDE RUNNING BOARDS
1	60K-56-0051	HARDWARE KIT #51

## II. TOOL LIST

1. A good friend
2. Basic tool kit
3. 13mm socket

## III. RUNNING BOARD INSTALLATION

1. Identify the left running board. It will have a bottle opener (arrow) on the left side.

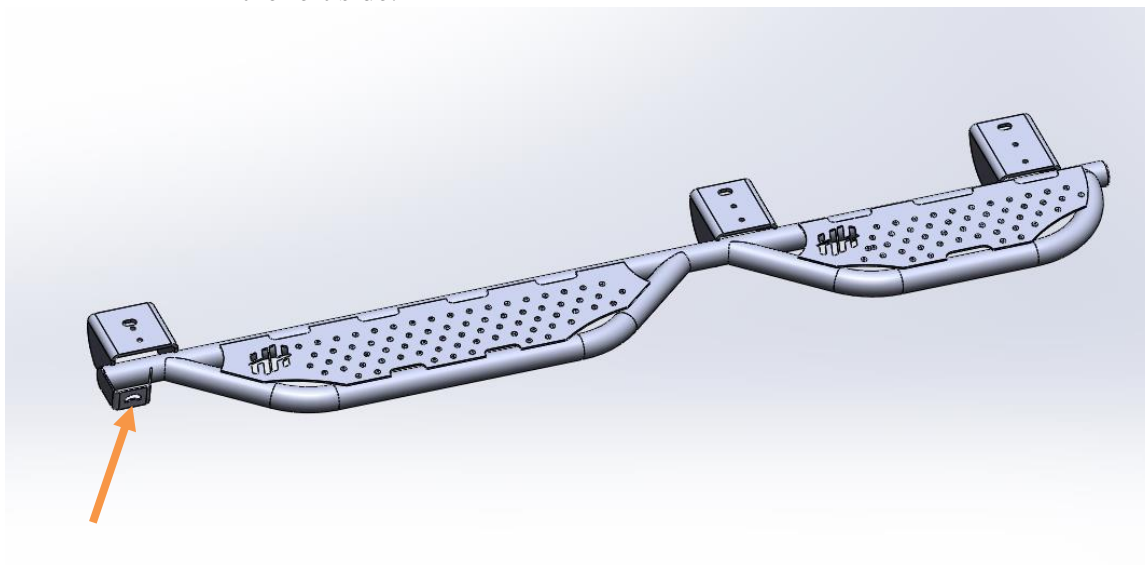

(Picture is for reference only; your running boards may differ.)

2. Have a good friend help you hold the running board up to the mounts and use nine M8-1.5 flange nuts to attach running board mounts to three sets of OEM studs on truck body.
3. Using 13mm socket, tighten hardware. Installation is now complete. Follow the same procedure for the right side of the vehicle.

Congratulations! Your installation is now complete.  
Thank you for your purchase.