

# 2013-20XX DODGE 1500

## FRONT BUMPER INSTALLATION INSTRUCTIONS



## SAFETY

**Know safety, no injury. Know injury, no safety. ~Author Unknown**

If there are any questions, call 1-855-HHTOUGH

- **READ ALL SAFETY INSTRUCTIONS BEFORE INSTALLATION**
  - FOLLOW ALL INSTRUCTIONS FOR PROPER ASSEMBLY
  - WEAR APPROPRIATE EYE PROTECTION
  - EXERCISE CARE WHEN LIFTING COMPONENTS
  - USE APPROPRIATE TORQUE FOR BOLTS
  - BLUE THREAD LOCKING COMPOUND IS RECOMMENDED ON ALL BOLT
  
- SUGGESTED TORQUE VALUES FOR STEEL GRADE SAE 5 BOLT

BOLT DIAMETER (INCH)	TREADS PER INCH	TORQUE (POUND-FEET)
1/4	20	7
5/16	18	14
3/8	16	25
7/16	14	40
1/2	13	60
9/16	12	88
5/8	11	120
3/4	10	200
7/8	9	302
1	8	466



## 2013-20XX DODGE 1500 FRONT BUMPER

### I. PARTS LIST

<u>QUANTITY</u>	<u>PART NUMBER</u>	<u>DESCRIPTION</u>
1	600-56-0419, 0454	2013-XX DODGE 1500 LOW PRO PRERUNNER
1	601-56-1941	PASSENGER FRAME MOUNT
1	601-56-1942	DRIVER FRAME MOUNT
1	60K-56-0063	HARDWARE KIT #63
1	60K-56-0064	HARDWARE KIT #64
2	601-56-2868	WELDNUT TAB 3
6	601-56-2316	OUTSIDE PLUG
6	307-13-0231	PARK ASSIST SENSOR GROMMET
6	443-10-0927	PUSH IN BUMPER 5/16" HOLE SIZE
6	601-56-2711	SENSOR CLIP

### II. TOOL LIST

1. Basic tool kit
2. 8mm socket
3. 10mm socket
4. 18mm socket
5. 3/4" socket
6. 9/16" wrench
7. 9/16" socket
8. Heavy duty scissors

### III. REMOVAL OF OEM BUMPER

1. Unplug OEM wiring fog light/sensor harnesses. (if applicable)

NOTE: The two plugs are located on the left side of the bumper above the fog light.



## 2013-20XX DODGE 1500 FRONT BUMPER

2. Underneath of vehicle remove 9 clips holding bottom shroud to OEM bumper. Remove bottom shroud and set aside.



3. Using an 18mm socket remove 3 nuts holding bumper to frame mount.(both sides)

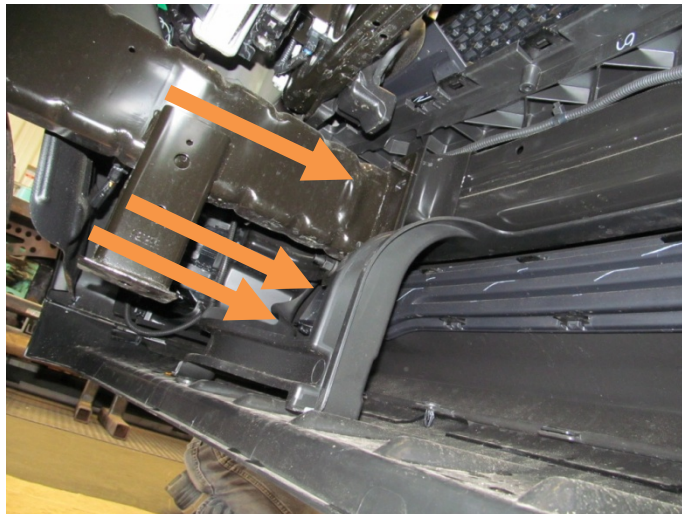

4. Carefully remove bottom lower OEM bumper and set aside.



5. Hold tow hook firmly and use an 18mm socket to remove bolt in bottom of tow hook. (both sides) Set tow hook aside.



6. Using an 8mm socket remove two screws attaching fender well to vehicle (both sides).



## 2013-20XX DODGE 1500 FRONT BUMPER

7. Using a 10mm socket remove one screw from exposed area inside fender. The bolt is gray in color and has captive washer facing downwards. (both sides)



8. Carefully pull plastic OEM bumper downward and toward the front of truck to dislodge plastic upper fascia from vehicle. Remove and set aside.



9. Using 10mm socket remove two bolts holding on center bumper support structure. (both sides)

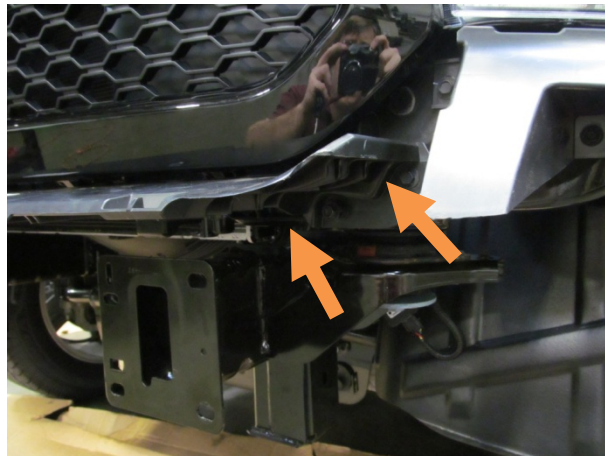



## 2013-20XX DODGE 1500 FRONT BUMPER

10. Rotate structure downward and push towards vehicle to remove.



11. Using 10mm socket remove three bolts holding side bumper support. Remove side bumper support and set aside. (both sides)

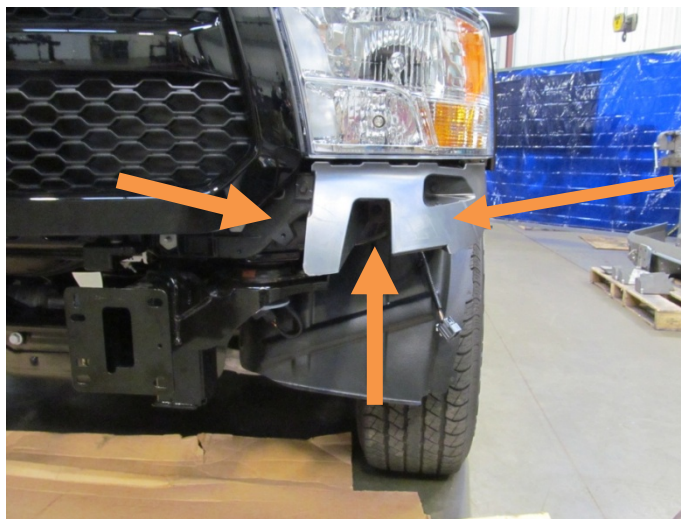

#### IV. PREPERATION OF HAMMERHEAD BUMPER FOR VEHICLES WITH SENSORS AND INSTALLATION

1. Carefully remove OEM sensors and wiring harness from OEM bumper. There are 8 plastic retainers sticking up through the top of the metal bumper. Push them down through the top.

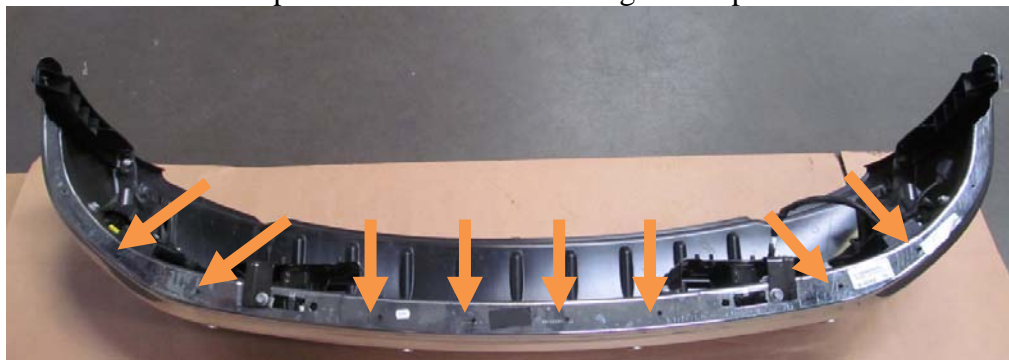



## 2013-20XX DODGE 1500 FRONT BUMPER

2. There are two metal clips that need to be removed from the OEM bumper.



3. Remove the sensors from the OEM grommets. Gently pry up on the top and bottom of the grommet to release the tabs retaining the sensor.



4. Now you can carefully remove the wiring harness and sensors from OEM bumper.

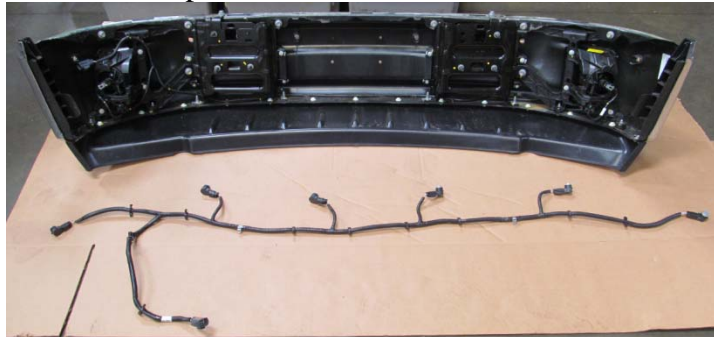

### V. INSTALLATION OF HAMMERHEAD BUMPER

1. For bumpers without sensors, install outside plugs. (601-56-2316) (qty-6)



2. For bumpers with sensors, install rubber grommets (307-13-0231) in bumper. Place a drop of dish washing soap on each sensor to lubricate it. Install OEM sensors in bumper. The sensor's plugs will face inward. **NOTE: DO NOT TWIST SENSOR WHILE INSTALLING. THIS WILL DAMAGE IT.**



## 2013-20XX DODGE 1500 FRONT BUMPER

3. Install rubber bumper (443-10-0927) (orange arrow) in sensor clip. (601-56-2711) (qty-6)

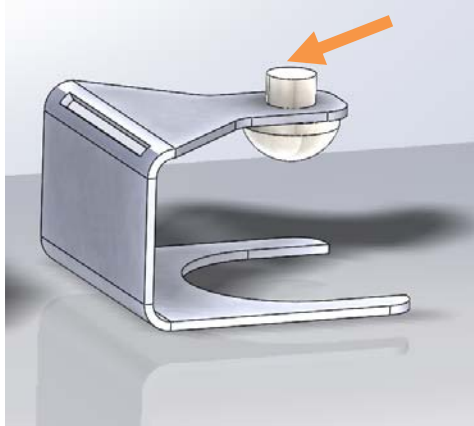

4. Slide sensor clip over grommet and ensure rubber bumper touches the back of the sensor. This clip will retain the sensor in the grommet.



5. Install OEM sensor wiring harness and plug sensors in.





## 2013-20XX DODGE 1500 FRONT BUMPER

6. In this step you will use hardware kit #63. Using eight 3/8"-16 x 1.50" bolts, sixteen 3/8" flat washers, and eight 3/8" lock washers and eight 3/8"-16 nuts, attach Hammerhead frame mounts to OEM frame flange. Use 9/16" socket and wrench. Do not fully tighten.



7. In this step you will use hardware kit #64. Using six 1/2"-13 x 2.00" bolts, six 1/2" flat washers, six 1/2" lock washers, and weld nut tabs (601-56-2868) fasten Hammerhead bumper to Hammerhead frame mounts. Align bumper to center of vehicle, and tighten all hardware using 3/4" socket.

NOTE: Align bumper a minimum of 1/4" below headlights. When truck flexes off-road, this distance allows your bumper and body to have clearance.

8. Plug in OEM wiring fog light/sensor harness. (if applicable)
9. Trim inner fenders to match Hammerhead bumper.



Congratulations! Your bumper installation is now complete.  
Thank you for your purchase.