

2015-20XX FORD F-150 & 2017-20XX F250-550 REGULAR CAB - CAB LENGTH

INSTALLATION INSTRUCTIONS



SAFETY

Know safety, no injury. Know injury, no safety. ~Author Unknown

If there are any questions, call 1-855-HHTOUGH

- **READ ALL SAFETY INSTRUCTIONS BEFORE INSTALLATION**
 - FOLLOW ALL INSTRUCTIONS FOR PROPER ASSEMBLY
 - WEAR APPROPRIATE EYE PROTECTION
 - EXERCISE CARE WHEN LIFTING COMPONENTS
 - USE APPROPRIATE TORQUE FOR BOLTS
 - BLUE THREAD LOCKING COMPOUND IS RECOMMENDED ON ALL BOLTS
 - SUGGESTED TORQUE VALUES FOR STEEL GRADE SAE 5 BOLTS

| BOLT DIAMETER (INCH) | TREADS PER INCH | TORQUE (POUND-FEET) |
|-------------------------|-----------------|------------------------|
| 1/4 | 20 | 7 |
| 5/16 | 18 | 14 |
| 3/8 | 16 | 25 |
| 7/16 | 14 | 40 |
| 1/2 | 13 | 60 |
| 9/16 | 12 | 88 |
| 5/8 | 11 | 120 |
| 3/4 | 10 | 200 |
| 7/8 | 9 | 302 |
| 1 | 8 | 466 |



2015-20XX Ford F-150, 2017-20XX F-250-550

I. PARTS LIST

| <u>QUANTITY</u> | <u>PART NUMBER</u> | <u>DESCRIPTION</u> |
|-----------------|--------------------|---------------------|
| 1 | 60P-56-0581 | RIGHT RUNNING BOARD |
| 1 | 60P-56-0582 | LEFT RUNNING BOARD |
| 1 | 60K-56-0096 | HARDWARE KIT #96 |

II. TOOL LIST

1. A good friend
2. Basic tool kit
3. 13mm socket

III. RUNNING BOARD INSTALLATION

1. Identify the left running board. It will have a bottle opener (arrow) on the left side.

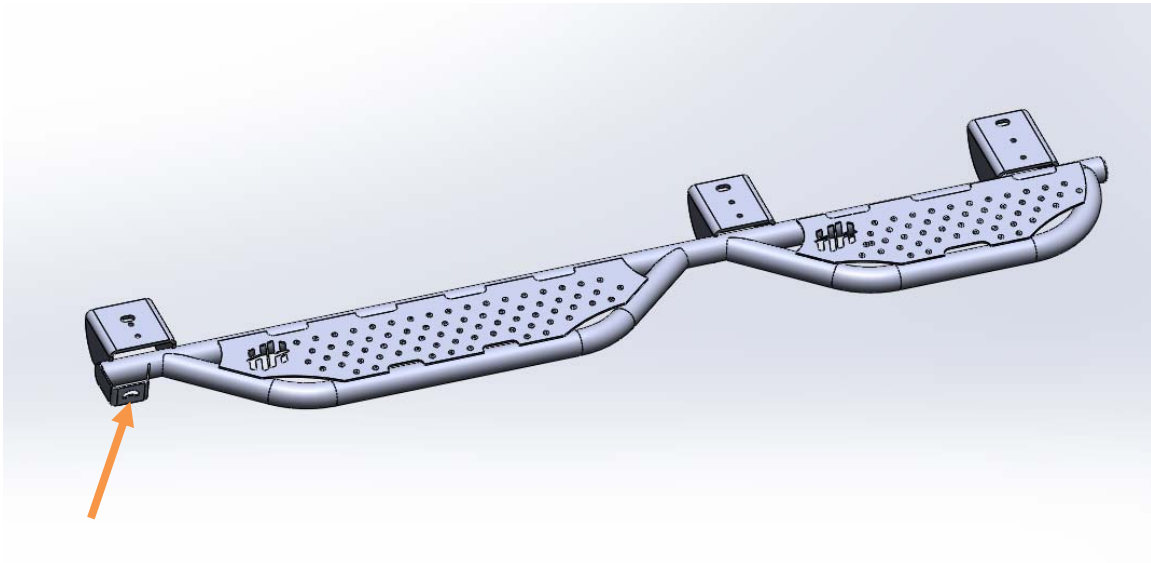

(Picture is for reference only; your running boards may differ.)

2. Have a good friend help you hold the running board up to the mounts and use six M8-1.5 flange nuts to attach running board mounts to two sets of OEM studs on truck body.
3. Using 13mm socket, tighten hardware. Installation is now complete. Follow the same procedure for the right side of the vehicle.

Congratulations! Your installation is now complete.
Thank you for your purchase.