

2010-20XX Dodge 2500-3500 Crew Cab LWB Bed Access

RUNNING BOARD INSTALLATION INSTRUCTIONS



SAFETY

Know safety, no injury. Know injury, no safety. ~Author Unknown

If there are any questions, call 1-855-HHTOUGH

- **READ ALL SAFETY INSTRUCTIONS BEFORE INSTALLATION**
 - FOLLOW ALL INSTRUCTIONS FOR PROPER ASSEMBLY
 - WEAR APPROPRIATE EYE PROTECTION
 - EXERCISE CARE WHEN LIFTING COMPONENTS
 - USE APPROPRIATE TORQUE FOR BOLTS
 - BLUE THREAD LOCKING COMPOUND IS RECOMMENDED ON ALL BOLTS
 - SUGGESTED TORQUE VALUES FOR STEEL GRADE SAE 5 BOLTS

BOLT DIAMETER (INCH)	TREADS PER INCH	TORQUE (POUND-FEET)
1/4	20	7
5/16	18	14
3/8	16	25
7/16	14	40
1/2	13	60
9/16	12	88
5/8	11	120
3/4	10	200
7/8	9	302
1	8	466



I. PARTS LIST

<u>QUANTITY</u>	<u>PART NUMBER</u>	<u>DESCRIPTION</u>
1	60P-56-0643	RIGHT SIDE RUNNING BOARDS
1	60P-56-0644	LEFT SIDE RUNNING BOARDS

II. TOOL LIST

1. A good friend
2. Basic tool kit
3. 18mm socket

III. VEHICLE PREPARATION

1. Using an 18mm socket, remove three cab mount bolts.
Note A: The front mount usually pours water out when the bolt is being removed.



Front mount



Middle mount



Rear mount

Note: Some trucks will have a cast metal dampener on the rear mount. It will not be reused.



IV. RUNNING BOARD INSTALLATION

1. Identify the left running board. It will have a bottle opener (arrow) on the left side.

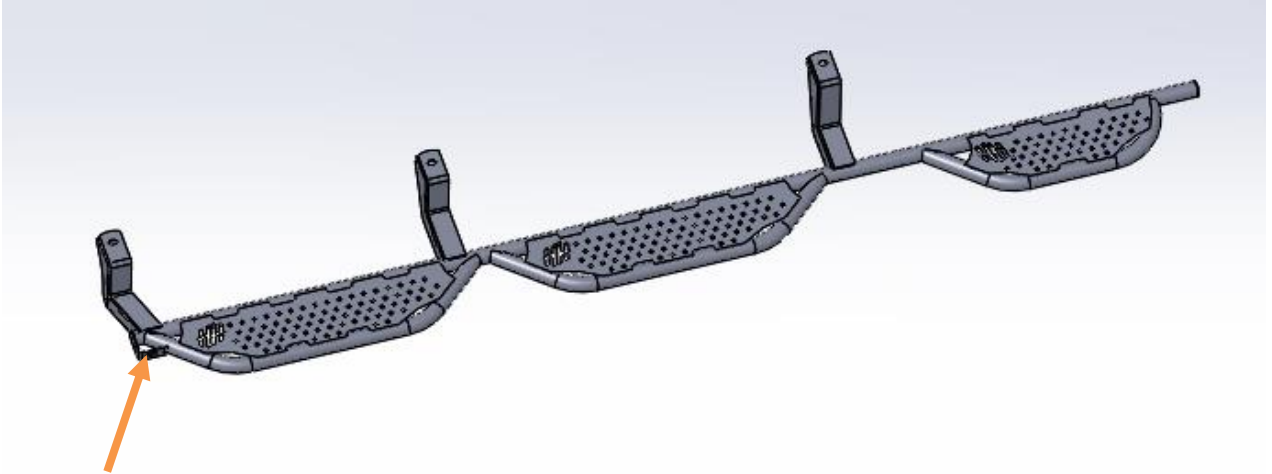

(Picture is for reference only; your running boards may differ.)

2. Have a good friend help you hold the running board up to the mounts.
3. Replace and tighten all OEM hardware. Installation is now complete. Follow the same procedure for the right side of the vehicle.

CONGRATULATIONS!!