

# 2010-20XX Dodge 2500-3500 Mega Cab – Cab Length RUNNING BOARD INSTALLATION INSTRUCTIONS



## SAFETY

**Know safety, no injury. Know injury, no safety. ~Author Unknown**

If there are any questions, call 1-855-HHTOUGH

- **READ ALL SAFETY INSTRUCTIONS BEFORE INSTALLATION**
  - FOLLOW ALL INSTRUCTIONS FOR PROPER ASSEMBLY
  - WEAR APPROPRIATE EYE PROTECTION
  - EXERCISE CARE WHEN LIFTING COMPONENTS
  - USE APPROPRIATE TORQUE FOR BOLTS
  - BLUE THREAD LOCKING COMPOUND IS RECOMMENDED ON ALL BOLTS
  - SUGGESTED TORQUE VALUES FOR STEEL GRADE SAE 5 BOLTS

BOLT DIAMETER (INCH)	TREADS PER INCH	TORQUE (POUND-FEET)
1/4	20	7
5/16	18	14
3/8	16	25
7/16	14	40
1/2	13	60
9/16	12	88
5/8	11	120
3/4	10	200
7/8	9	302
1	8	466



## I. PARTS LIST

ITEM NO	QTY	PART NUMBER	DESCRIPTION	
1	1	60P-56-0694	RIGHT RUNNING BOARD	-
2	1	60P-56-0695	LEFT RUNNING BOARD	-

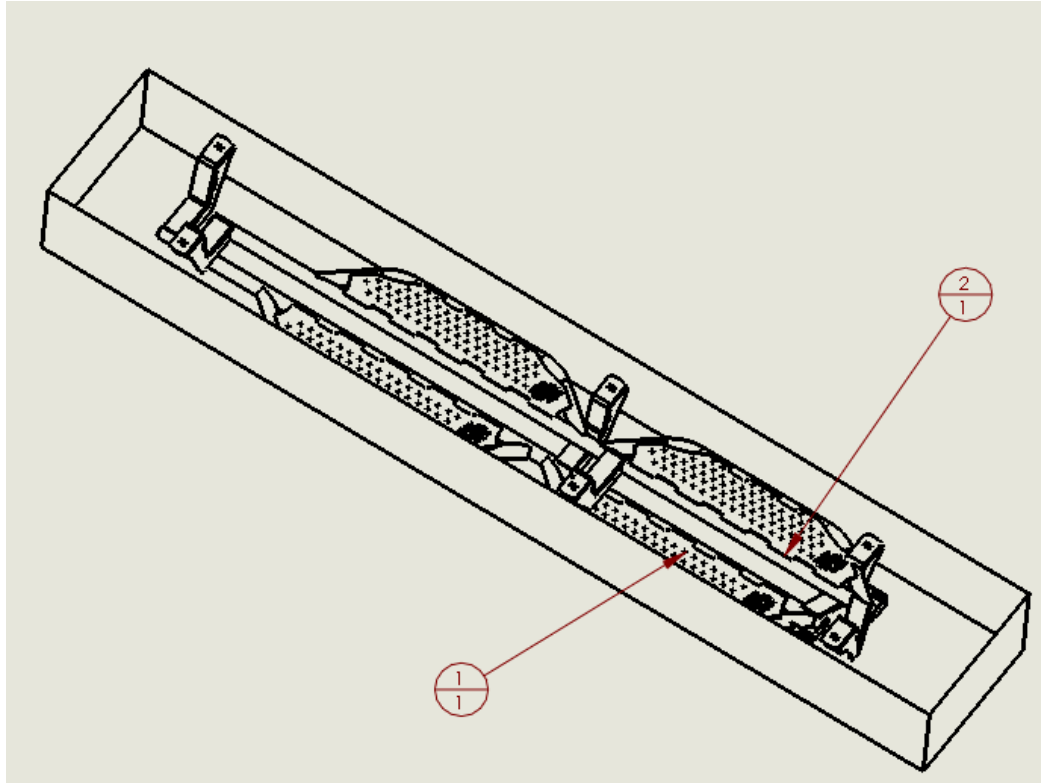

## II. TOOL LIST

1. A good friend
2. Basic tool kit
3. 18mm socket

## III. VEHICLE PREPARATION

1. Using an 18mm socket, remove three cab mount bolts.  
Note A: The front mount usually pours water out when the bolt is being removed.



Front mount



Middle mount



Rear mount

Note: Some trucks will have a cast metal dampener on the rear mount. It will not be reused.

## IV. RUNNING BOARD INSTALLATION

1. Identify the left running board. It will have a bottle opener (arrow) on the left side.

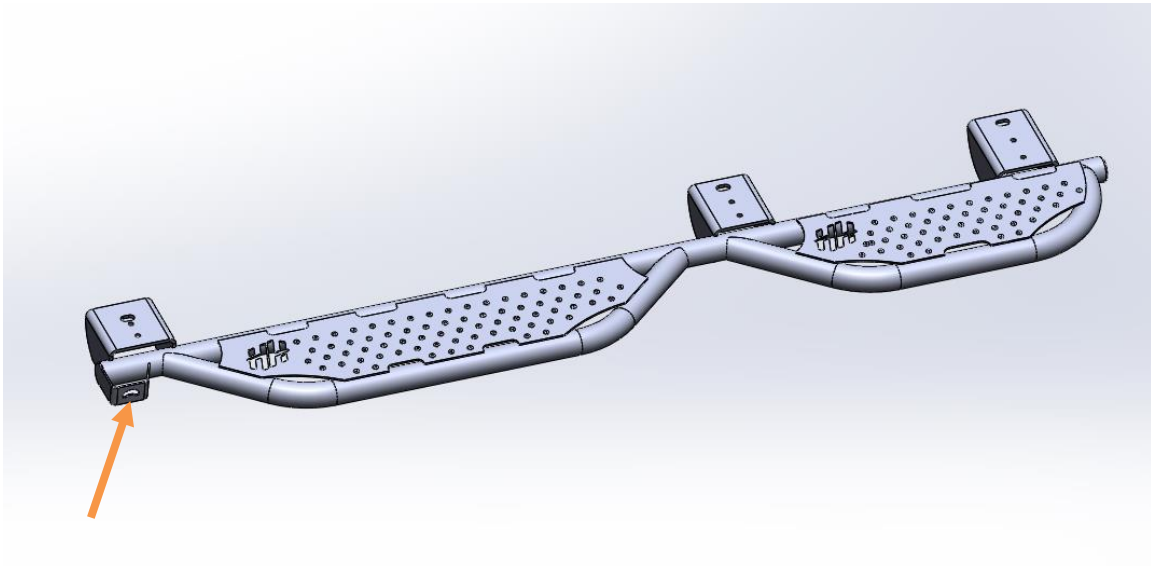

(Picture is for reference only; your running boards may differ.)

2. Have a good friend help you hold the running board up to the mounts.
3. Replace and tighten all OEM hardware. Installation is now complete. Follow the same procedure for the right side of the vehicle.

**CONGRATULATIONS!!**